

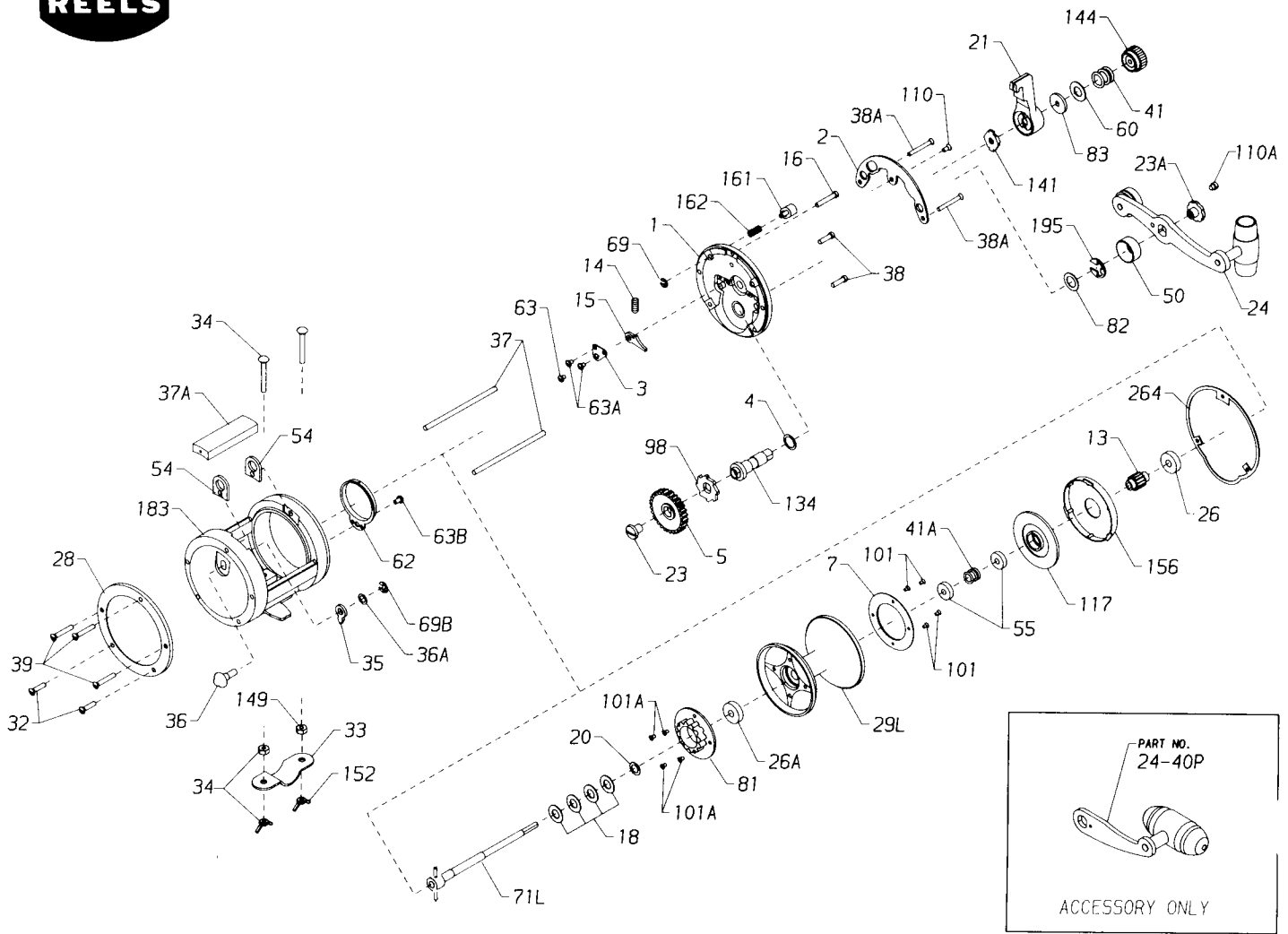

PARTS AND PRICE LIST FOR MODEL 40GLS



Key No.	Part No.	Description	Price
1	1-40	Right Side Plate	\$ 9.50
2	2-40	Quadrant Ring	5.30
3	3-40	Bridge Ratchet	2.15
4	4-40	Gear Stud Washer	.45
5	5-40	Main Gear	7.30
7	7-40	Metal Drag Washer	5.60
13	13-40	Pinion Gear	6.00
14	14-40	Dog Compression Spring	.50
15	15-40	Dog Ratchet	1.15
16	16-9	Right Side Spacer Screw (Top)	.35
18	18-40	Clutch Spring (4)	.70
20	20-40	Thrust Washer	.35
21	21-40	Cam Lever	4.65
23	23-6	Gear Mounting Screw	1.05
23A	23-114	Handle Screw	2.25
24	24-40	Counterbalanced Handle	10.60
26	26-40	Ball Bearing Drive Plate	11.25
26A	26-40	L.S. Spool Bearing	11.25
28	28-40	Left Side Plate Ring	6.00
29L	29L-40	Spool	43.70
32	32-17	Left Side Ring Screw (2)	.35
33	33-200	Rod Clamp	3.25
*33R	33R-200	Ringed Rod Clamp	4.80
34	34-200	Rod Clamp Screws w/Nuts	1.20
35	35-40	Click Tongue	1.05
36	36N-209	Click Button	.80
36A	36A-40	Click Tongue Washer	.35
37	37-40	Post (2)	1.65
37A	37A-40	Top Spacer Bar	4.60
38	38-8	Lower Plate Screw (2)	.35
	24-40P	OPTIONAL Power Handle	11.20
38A	38-40	Right Side Post Screw (2)	.35
39	39-9	Left Side Post Screw (3)	.35

Key No.	Part No.	Description	Price
41	41-40	Preset Knob Spring	\$.70
41A	41-109	Bearing Spring	.60
50	50-40	Gear Stud Cover	2.60
54	54-113	Harness Lug (2)	1.45
55	55-6	Spool Ball Bearing (2)	11.25
60	60-40	Lever Backing Washer	.85
62	62-40	Click Spring	1.70
63	63-349	Bridge Screw	.70
63B	63-500S	Click Spring Mounting Screw (1)	.70
63A	63-500S	Bridge Mtg. Screw (2)	.70
69	69B-50	Retaining Ring (Strike Button)	.70
69B	69B-600	Retaining Ring (Click Tongue)	.75
71	71-40	Spool Spindle Assembly	8.05
81	81-40	Click Ratchet	2.65
82	82-40	Handle Shim	.35
83	83-40	Preset Collar	2.45
98	98-40	Main Gear Ratchet	1.30
101	101-30	Drive Plate Screw (4)	.40
101A	101-30	Click Ratchet Mtg. Screw (4)	.40
110	110-50	R.S. Quadrant Screw	.45
110A	110-60	Handle Lock Screw	.35
117	117-40	Drive Plate Assembly	10.65
134	134-40	Gear Stud	4.60
141	141-40	Cam Follower	2.50
144	144-40	Preset Knob	5.75
149	149-200	Hex Nut (2)	.40
152	152-200	Wing Nut (2)	.40
156	156-40	Drag Cover	2.65
161	161-40	Strike Button	1.05
162	162-50	Strike Button Spring	.40
183	183-40	Frame w/Stand	31.00
195	195-40	Gear Stud Retaining Ring	.50
264	264-40	R.S. Plate Gasket	11.20

*Not Shown